

Inductive proximity switch

IFFM 12

sample drawing

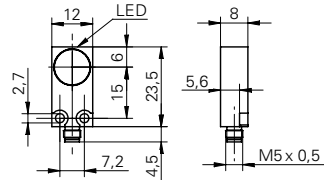

general data

mounting type	shielded
nominal sensing distance S_n	4 mm
hysteresis	3 ... 20 % of S_r
output indicator	LED red

electrical data

switching frequency	< 2 kHz
voltage supply range +Vs	10 ... 30 VDC
current consumption max.	10 mA
voltage drop V_d	< 2 VDC
output current	< 200 mA
short circuit protection	yes
reverse polarity protection	yes

mechanical data

type	rectangular
material (sensing face)	PBT
housing material	brass nickel plated
dimension	12 mm
housing length	23,5 mm
connection types	connector M5

ambient conditions

operating temperature	-25 ... +75 °C
protection class	IP 67

order reference

IFFM 12N17A3/S05L
IFFM 12N37A3/S05L
IFFM 12P17A3/S05L
IFFM 12P37A3/S05L

output circuit

NPN make function (NO)
 NPN break function (NC)
 PNP make function (NO)
 PNP break function (NC)

sample picture

